

| Revision | By | Appd. | YY.MM.DD |
|--|----|-------|----------|
| | | | |
| | | | |
| | | | |
| | | | |
| DCB FILING | | GM | BD |
| OMEGA ENVIRONMENTAL SERVICES | | GM | BD |
| GMH FILING | | GM | BD |
| Issued | | By | Appd. |
| File Name: 00004B_LSC-100_Code Compliance Plan.dwg | | Dwn. | Chkd. |
| | | Dgn. | YY.MM.DD |

CODE COMPLIANCE LEGEND:

- (E) - ON-GRADE EXIT DISCHARGE
- (with dashes) --- - ONE HOUR FIRE RESISTANT WALL CONSTRUCTION
- (with dots) --- - TWO HOUR FIRE RESISTANT WALL CONSTRUCTION
- F.E. - FIRE EXTINGUISHER
- - - - -> - PATH OF EGRESS TRAVEL
- (E with X) - ILLUMINATED EXIT SIGN
- - - - - (with stairs) - EXIT STAIR
- (Hatched Area) - AREA OF WORK (4,500 SF)

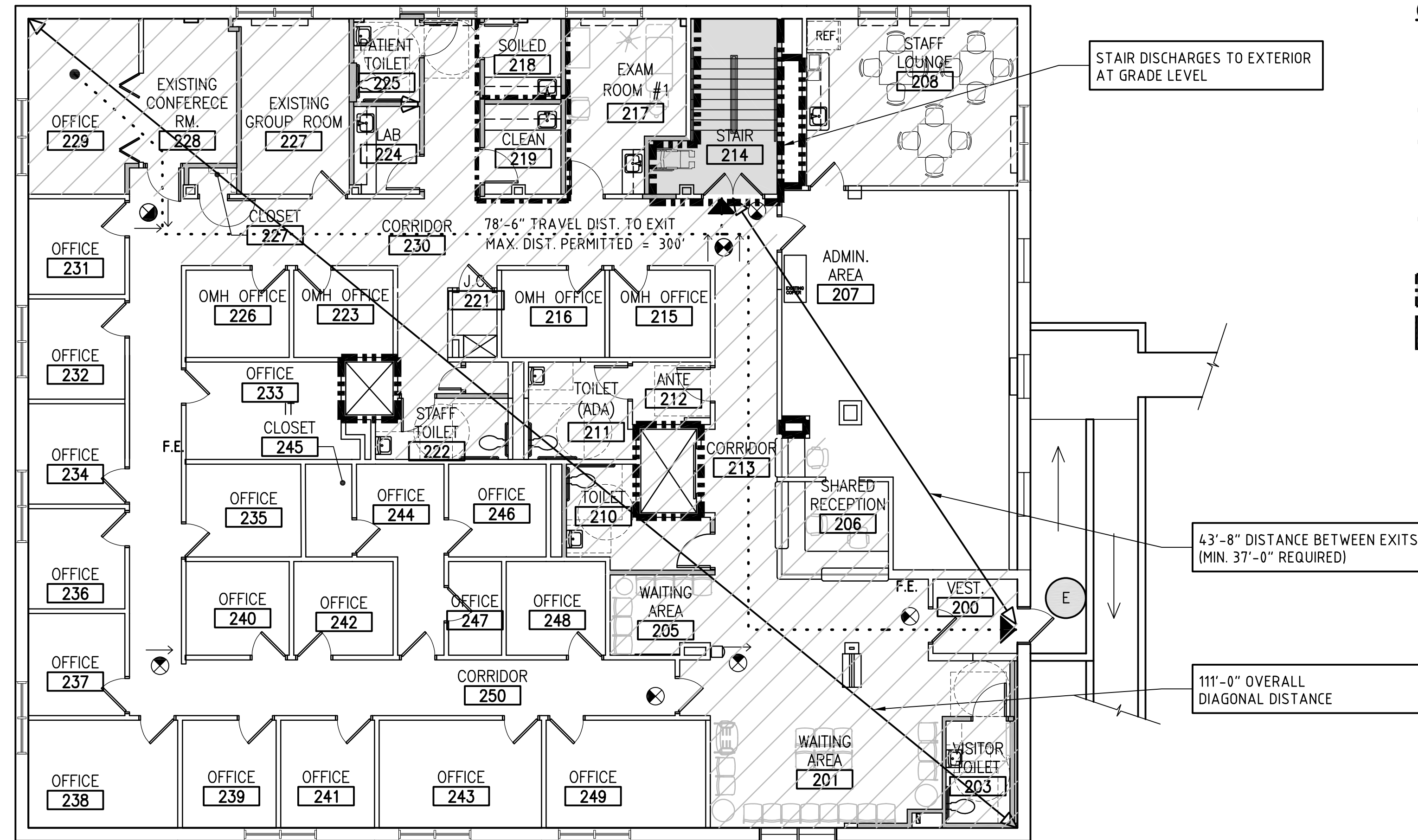

SECOND FLOOR PLAN

SCALE: 1/8" = 1'-0"

APPLICABLE CODES:

| Code | Year | Reference | Year |
|--|------|--|------|
| NFPA LIFE SAFETY CODE 101 (NFPA) | 2015 | NEW YORK CITY MECHANICAL CODE (NYC MC) | 2022 |
| NATIONAL ELECTRICAL CODE (NEC) | 2014 | NEW YORK CITY PLUMBING CODE (NYC PC) | 2022 |
| NEW YORK CITY ELECTRICAL CODE (NYC EEC) | 2011 | ICC / ANS A117.1 | 2009 |
| NEW YORK CITY BUILDING CODE (NYC BC) | 2022 | ADA STANDARDS FOR ACCESSIBLE DESIGN | 2010 |
| NEW YORK CITY FIRE CODE (NYC FC) | 2022 | | |
| NEW YORK CITY ENERGY CONSERVATION CODE (NYC ECC) | 2020 | | |
| NEW YORK CITY FUEL GAS CODE (NYC FGC) | 2022 | | |

PROJECT SCOPE OF WORK

LEVEL 2 ALTERATIONS:
INTERIOR RENOVATIONS ALLOWING EXISTING C.D.T. PROGRAM ON SECOND FLOOR TO BE EXPANDED TO INCLUDE A PRIMARY CARE CLINIC.
EXISTING BUILDING IS FULLY EQUIPPED WITH AN AUTOMATIC SPRINKLER SYSTEM.

| Code | 2022 NYC BC REFERENCE | 2022 NYC BC REQUIREMENT | NFPA CODE REFERENCE | 2015 NFPA 101 REQUIREMENT | ACTUAL COMPLIANCE |
|--|---|---|---------------------|--|--|
| OCCUPANCY CLASSIFICATION | SECTION BC 304.1 | EXISTING - EDUCATION GROUP E CHANGED TO - BUSINESS GROUP B | CHAPTER 38 | NEW BUSINESS OCCUPANCY | PROJECT AREA WILL COMPLY WITH NYC BC 2022 AND NFPA 2015 REQUIREMENTS |
| CONSTRUCTION CLASSIFICATION | TABLE 601 | TYPE 11A | TABLE A.8.2.1.2 | TYPE II (111) | COMPLIES |
| HEIGHT AND AREA LIMITS | TABLE 504.3 TABLE 506.2 TABLE 504.4 | 85 FEET 75,000 SF/STORY 7 STORIES | N/A | N/A | EXISTING BUILDING 33' HIGH, 6,455 SF PER STORY, 2 STORY HIGH COMPLIES |
| FIRE RESISTANCE RATING FOR BUILDING ELEMENTS | | | | | |
| PRIMARY STRUCTURAL FRAMING | TABLE 601 | 1 HOUR | N/A | N/A | COMPLIES |
| BEARING WALLS | | | | | |
| - INTERIOR | TABLE 601 | 1 HOUR | | 1 HOUR | COMPLIES |
| - EXTERIOR | TABLE 601 | 1 HOUR | | 1 HOUR | COMPLIES |
| NON-BEARING WALLS | | | TABLE A.8.2.1.2 | | |
| - INTERIOR | TABLE 601 | 0 HOURS | | 0 HOURS | COMPLIES |
| - EXTERIOR | TABLE 602 | 0 HOUR (FIRE SEPARATION GREATER THAN 30 FEET) 1 HOUR (FIRE SEPARATION LESS THAN 30 FEET) | | 0 HOURS 0 HOURS | COMPLIES |
| STRUCTURAL FRAME | | | | | |
| - COLUMNS AND GIRDERS, BEAMS, TRUSSES AND SPANDRELS WITH DIRECT CONNECTIONS TO COLUMNS AND BRACING DESIGNED TO CARRY GRAVITATIONAL LOADS | N/A | N/A | TABLE A.8.2.1.2 | 1 HOURS | COMPLIES |
| FLOOR & FLOOR/CEILING CONSTRUCTION | TABLE 601 | 1 HOUR | TABLE A.8.2.1.2 | 1 HOUR | COMPLIES |
| ROOF & ROOF CEILING CONSTRUCTION | TABLE 601 | 1 HOUR | TABLE A.8.2.1.2 | 1 HOUR | COMPLIES |
| FIRE SEPARATION ASSEMBLIES | | | | | |
| SHAFT ENCLOSURES | 713.4 | 2-HOUR FIRE RESISTANCE RATING (3+ STORIES OR MORE) 1-HOUR FIRE RESISTANCE RATING (LESS THAN STORIES) | N/A | | NOT APPLICABLE - EXISTING RATED SHAFTS CONSTRUCTION TO REMAIN - NO WORK |
| STAIR ENCLOSURES | 1023.2 | 1-HOUR FIRE RESISTANCE RATING (+4 STORIES) 2-HOUR FIRE RESISTANCE RATING (+4 STORIES) | 7.1.3.2 | 1-HOUR FIRE RESISTANCE RATING (+4 STORIES) 2-HOUR FIRE RESISTANCE RATING (+4 STORIES) | NOT APPLICABLE - EXISTING RATED STAIR ENCLOSURES TO REMAIN - NO WORK |
| SPECIAL DETAILED REQUIREMENTS BASED ON USE AND OCCUPANCY | | | | | |
| CORRIDOR WALLS | TABLE 1020.1.1 | 0-HOURS FOR BUSINESS OCCUPANCY IF BUILDING IS EQUIPPED WITH AUTO SPRINKLER SYSTEM | 38.3.6.1(3) | 0 HR FIRE RESISTANCE RATING FOR BUILDINGS EQUIPPED WITH AN AUTO SPRINKLER SYSTEM | COMPLIES |

INTERIOR FINISHES

| Code | Requirement | Code | Requirement | Code | Requirement |
|--------------|---|--|-------------|--|-------------|
| TABLE 803.11 | WALL AND CEILING FINISHES IN CORRIDORS AND ENCLOSURES FOR EXIT ACCESS STAIRWAYS AND EXIT ACCESS RAMPS | CLASS B (FOR BUILDINGS WITH AUTO SPRINKLER SYSTEM) | 38.3.3.2.1 | CLASS A OR B | COMPLIES |
| TABLE 803.11 | WALL AND CEILING FINISHES IN INTERIOR EXIT STAIRWAYS, INTERIOR EXIT RAMPS AND EXIT PASSAGEWAYS. | CLASS B (FOR BUILDINGS WITH AUTO SPRINKLER SYSTEM) | 38.3.3.2.1 | CLASS A OR B | COMPLIES |
| TABLE 803.11 | WALL AND CEILING FINISHES IN ROOMS AND ENCLOSED SPACES | CLASS B (FOR BUILDINGS WITH AUTO SPRINKLER SYSTEM) | 38.3.3.2.2 | CLASS A, B OR C | COMPLIES |
| 804.4.1 | NEWLY INSTALLED FLOOR FINISHES | CLASS II | 38.3.3.3 | INTERIOR FLOOR FINISHES IN EXIT ENCLOSURES, SHALL BE CLASS I OR II | COMPLIES |

MAXIMUM FLOOR AREA ALLOWANCES PER OCCUPANT

| Code | Requirement | Code | Requirement |
|----------------|----------------|--------------|---|
| TABLE 1004.1.3 | BUSINESS AREAS | 100 GROSS SF | TABLE 7.3.1.2 FOR BUSINESS USE, NON-CONCENTRATED 100 GROSS SF PER OCCUPANT |

EGRESS WIDTH AND CAPACITY FACTORS

| Code | Requirement | Code | Requirement | Code | Requirement |
|----------|-------------------------|---|---------------|-------------------------|-------------|
| 1005.3.1 | STARWAYS | 0.3 INCHES (FOR BUILDINGS WITH AUTO SPRINKLER SYSTEM) | TABLE 7.3.3.1 | 0.3 INCHES PER OCCUPANT | COMPLIES |
| 1005.3.2 | OTHER EGRESS COMPONENTS | 0.2 INCHES (FOR BUILDINGS WITH AUTO SPRINKLER SYSTEM) | TABLE 7.3.3.1 | 0.2 INCHES PER OCCUPANT | |

EXIT ACCESS TRAVEL DISTANCE

| Code | Requirement | Code | Requirement | Code | Requirement |
|----------------|-----------------------------|---|-------------|------|-------------------------------|
| TABLE 1017.2 | ANY POINT IN A ROOM TO EXIT | 300' (FOR BUILDINGS WITH AUTO SPRINKLER SYSTEM) | 38.2.6 | 300' | COMPLIES (SEE EXITTING PLANS) |
| TABLE 1006.2.1 | COMMON PATH OF TRAVEL | 100' (FOR BUILDINGS WITH AUTO SPRINKLER SYSTEM) | 38.2.5.3.1 | 100' | COMPLIES (SEE EXITTING PLANS) |

CORRIDOR WIDTH

| Code | Requirement | Code | Requirement | Code | Requirement |
|--------------|------------------------|--|-------------|---|-------------|
| TABLE 1020.2 | MINIMUM CORRIDOR WIDTH | MINIMUM WIDTH DEPENDENT ON OCCUPANT LOAD BUT NOT LESS THAN 44 INCHES | 38.2.3.2 | MIN. 44 IN. IN CLEAR AND UNOBSTRUCTED WIDTH SERVICING AN OCCUPANCY LOAD OF 50 OR MORE | COMPLIES |

EGRESS DOOR WIDTH

| Code | Requirement | Code | Requirement | Code | Requirement |
|------------|--------------------|--|-------------|---|-------------|
| 1010.1.1.1 | MINIMUM DOOR WIDTH | SUFFICIENT FOR OCCUPANT LOAD AND SHALL PROVIDE 32 INCHES MINIMUM CLEAR WIDTH | 7.2.1.2.3.2 | 32 IN. MINIMUM CLEAR WIDTH FOR DOORS IN A MEANS OF EGRESS | COMPLIES |

DEAD END CORRIDORS

| Code | Requirement | Code | Requirement |
|--------------|--|------------|---|
| TABLE 1020.4 | 50 FEET (FOR BUILDINGS WITH AUTO SPRINKLER SYSTEM) | 38.2.5.2.1 | 50 FEET (FOR BLDGS. WITH AUTO SPRINKLER SYSTEM) |

CEILING HEIGHTS (HEADROOM)

| Code | Requirement | Code | Requirement |
|--------|----------------|---------------------|--------------------------------|
| 1003.2 | EXIT CORRIDORS | NOT LESS THAN 7'-6" | 7.1.5.1 NOT LESS THAN 7'-6" |

U:\22530000\architecture\sheet\225300004_BLM_LSC-100_Code Compliance Plan.dwg
2/24/2024 10:16:11 AM By: mcastillo